

Commercial Property Adjacent to SJO Airport and Walmart Alajuela

\$9,000,000

ID: 13361

📍 Alajuela, Alajuela

Property Type: Land • Size: 54,646 SQ M •

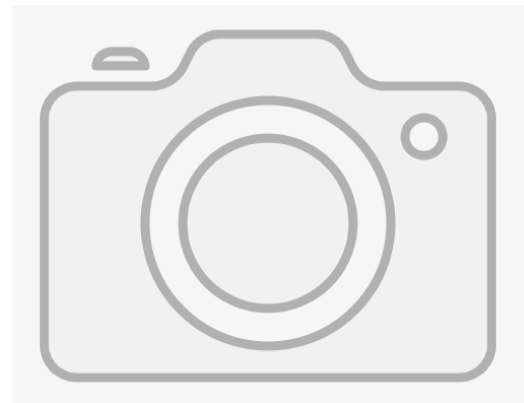
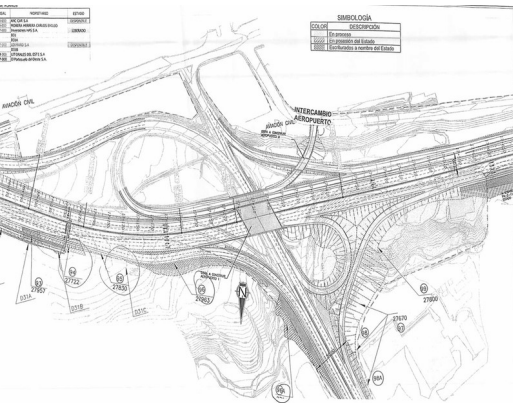

- Status: Active/Published
- Acreage
- Commercial

Property Description

This 13.58 acre property is located adjacent to a Walmart Supercenter and Juan Santamaria International Airport and is on the intersection of Rt 1 and Radial Francisco Orlich. Within the general area is one of the largest malls in Central America, a Courtyard by Marriott, and San Rafael Hospital. Total Area 54.646,00m of which around 275 meters is highway frontage.

Additional

- ID 13361
- For Sale
- \$9,000,000
- Active/Published
- Land

Costa Rica Direct: +506 2656 0856

US Number: +1 814 500 3379



80 m Oeste de la Iglesia Catolica, Guanacaste, Samara, 50206